



Advanced Cutting Technology



FOLLOW ALL INSTALLATION AND MAINTENANCE INSTRUCTIONS IN THIS SHEET AND THOSE IN YOUR CHAIN SAW OPERATOR'S MANUAL.



WEAR APPROVED EYE, EAR, HEAD, AND FACE PROTECTION.



ALWAYS WEAR PROTECTIVE CLOTHING AND GLOVES WHEN USING THE SHARPENER.



DO NOT PRESS THE TREADED FOOT WITH YOUR HANDS, YOUR FEET, OR AGAINST THE GROUND AS THAT WILL BRING THE CUTTING CHAIN TOO CLOSE TO YOUR HANDS, ARMS, LEGS OR FEET AND COULD RESULT IN SERIOUS PERSONAL INJURY.

### Original Instructions:

PowerSharp® is a system that includes the PowerSharp® chain, the PowerSharp® guide bar, and the PowerSharp® barmount sharpener. Together, they work to make sharpening simple and easy.

**WARNING!** Saw motor must be off!

### ⚠ WARNING:

**THERE IS RISK OF SERIOUS PERSONAL INJURY TO THE SAW OPERATOR DUE TO THE CHAIN JUMPING OFF THE GUIDE BAR IF THE SAW CHAIN IS NOT INSTALLED AND TENSIONED PROPERLY. FOLLOW ALL INSTALLATION AND MAINTENANCE INSTRUCTIONS IN THIS SHEET AND THOSE IN YOUR CHAIN SAW OPERATOR'S MANUAL.**

### BAR & CHAIN MOUNTING INSTRUCTIONS

Wear gloves. With the chain saw off and cool, remove the old bar and chain. Install your new bar and chain as follows:

**IMPORTANT:** Standard PowerSharp® bars may not work on saws equipped for Intenz® bars. Before replacing an Intenz® bar with a standard PowerSharp® guide bar, check that your saw has a tensioning mechanism on the saw (see your saw operators manual).

- 1) Place the guide bar on the mounting studs.
- 2) Loop the new chain onto the drive sprocket with teeth cutting edges facing **away from the drive sprocket** along top edge of the guide bar.
- 3) Feed the chain into the groove of the bar and slide the bar away from the motor to remove slack from the chain. Adjust the position of the bar adjusting pin until it engages the hole in the bar.
- 4) Replace the drive sprocket cover with the nuts and finger tighten.

**IMPORTANT:** The saw chain must be properly tensioned before using. See Tensioning Instructions below.

\* **To even bar wear and maximize bar life, invert the bar occasionally.**

### TENSIONING INSTRUCTIONS

- 1) With the bar-mounting nuts only finger tight, hold up the nose of the bar (FIG. A) and tighten the bar adjusting screw. (The location of the adjusting screw varies. See your saw operator's manual.)
- 2) Tighten the bar-mounting nuts securely.

**Chain tension is correct when, with some effort, with a gloved hand you are able to pull the chain smoothly around the bar. The chain should touch the underside of the bar rail (FIG. B).**

During early life use, run the chain around the guide bar, not cutting for a minute or two (for gasoline-powered saws, run at slow speed), making sure the chain is getting a good supply of oil. Stop the motor and check the chain tension. If it has loosened, readjust.

After a short period of use, allow the chain to cool and once again recheck the tension. Watch tension carefully for the first half-hour and periodically throughout the life of the chain, readjusting as required when the chain and bar are cool to the touch. Never tighten chain when it is hot.

Lubricate your chain properly with good quality bar and chain lubricant. Make certain the chain is getting an adequate supply of oil – oil should be thrown from the nose of the bar when running, but not in the cut. For gasoline-powered saws, you should use a full tank of oil for each tank of fuel.

When cutting under very cold conditions, bar and chain oil may be diluted with up to 25-percent kerosene or diesel fuel to ensure an adequate flow of oil.

### USING THE BAR-MOUNT SHARPENER

The PowerSharp® bar-mount sharpener requires the installation of a genuine PowerSharp® sharpening stone prior to first use. The stone is packaged with PowerSharp® chain and should be replaced with every new chain.

**IMPORTANT:** The PowerSharp® bar-mount sharpener is for use **ONLY** with PowerSharp® chain. NEVER attempt to sharpen other chain with the bar-mount sharpener. Damage to the chain and sharpener will occur.

**IMPORTANT:** PowerSharp® chain uses unique top-sharpening cutters and can only be sharpened with a genuine PowerSharp® bar-mount sharpener.

**⚠ WARNING: ALWAYS WEAR PROTECTIVE CLOTHING, GLOVES, AND EYE PROTECTION WHEN USING THE SHARPENER.**

### INSTALL THE SHARPENING STONE

Unlatch the bar-mount sharpener cover by pulling up on the tip portion of the latch. Open the bar-mount sharpener cover (Fig. A) and insert the stone into the mounting slot as shown (Fig. B). Ensure that the stone is completely seated to prevent loss during operation.

### ATTACH THE BAR-MOUNT SHARPENER TO THE BAR

**IMPORTANT:** Always position arrow on bar-mount sharpener facing up.

**⚠ WARNING: NEVER ATTACH OR REMOVE THE BAR-MOUNT SHARPENER WITH THE CHAIN SAW MOTOR RUNNING.**

**⚠ CAUTION: Always wear gloves when installing or removing the bar-mount sharpener and take care not to pinch fingers when closing the sharpener cover.**

- 1) Clean debris from the surface of the bar and the sharpener bar mounting area.
- 2) Unlatch and open the cover of the bar-mount sharpener.
- 3) With cover open and motor off, slide the two steel guide pins through the guide holes in the bar (Fig C) until the sharpener is flush against the bar.
- 4) Close the cover until the longest pin is slightly protruding above the cover.
- 5) Securely latch the cover by pushing the tip of the latch towards the sharpener cover until the latch clicks into position and is flush with the cover (Fig D).

**⚠ WARNING: WHEN THE SHARPENER IS ASSEMBLED ON THE BAR, THE LONGEST PIN MUST BE VISIBLE ABOVE THE LATCH AND THE LATCH MUST CLICK INTO PLACE. IF NOT, DO NOT USE THE SHARPENER. DO NOT USE THE SHARPENER IF ANY COMPONENT IS BROKEN. SERIOUS PERSONAL INJURY COULD RESULT.**

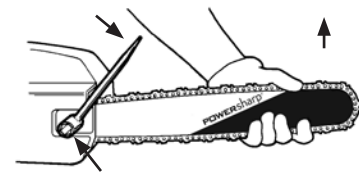

FIG. A Bar-Mounting Nuts

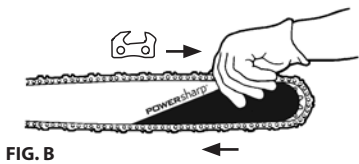

FIG. B

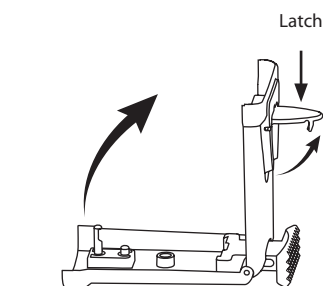

FIG. A

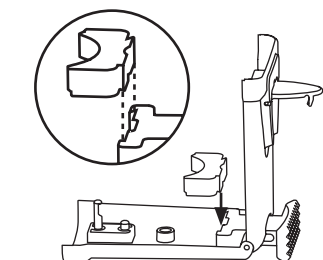

FIG. B

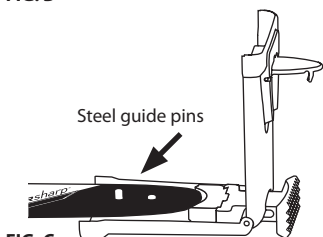

FIG. C

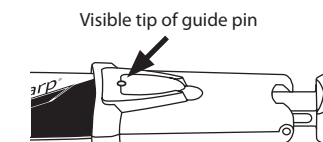

FIG. D



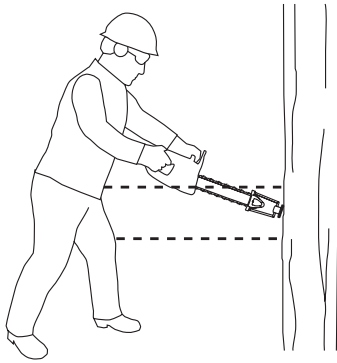

FIG. E

## USING THE BAR-MOUNT SHARPENER ./.

### SHARPENING THE CHAIN

1) Select a location that provides good footing and a solid surface to push against. 2) With the saw at full throttle, lightly press the treaded foot of the bar-mount sharpener against a firm surface that is between knee to waist high for 3-5 seconds (Fig E). Sparks will be visible when the cutters are in contact with the sharpening stone.

**⚠ CAUTION:** Sharpening with the PowerSharp® system produces low energy sparks.

**⚠ WARNING:** POWERSHARP® SHOULD NOT BE USED IN THE PRESENCE OF EXPOSED, EXTREMELY FLAMMABLE MATERIALS SUCH AS GASOLINE AND ACETYLENE.

**⚠ WARNING:** BEFORE ENGAGING POWERSHARP®, REMOVE ALL RESIDUAL GASOLINE FROM THE CHAIN SAW, BAR, AND CHAIN.

**⚠ WARNING:** DO NOT PRESS THE TREADED FOOT WITH YOUR HANDS, YOUR FEET, OR AGAINST THE GROUND AS THAT WILL BRING THE CUTTING CHAIN TOO CLOSE TO YOUR HANDS, ARMS, LEGS OR FEET AND COULD RESULT IN SERIOUS PERSONAL INJURY.

**⚠ WARNING:** DO NOT PRESS THE TREADED FOOT AGAINST OBJECTS THAT ARE ABOVE YOUR SHOULDERS OR BELOW YOUR KNEES.

**IMPORTANT:** DO NOT APPLY TOO MUCH FORCE WHEN SHARPENING. Excessive force can reduce the performance of the sharpening stone.

**IMPORTANT:** It is normal to see a small amount of sparks and smoke emerging from the bar-mount sharpener during sharpening as the cutters contact the stone and friction heats the bar and chain oil. If excessive amounts of either sparks or smoke is present, immediately reduce the pressure being applied to the sharpener.

**IMPORTANT:** After 5 or more chains the sparks may increase. If the volume of sparks exiting the bar-mount sharpener increases significantly, the bar-mount sharpener needs to be replaced.

### REMOVE THE BAR-MOUNT SHARPENER

**⚠ WARNING:** NEVER REMOVE THE BAR-MOUNT SHARPENER WITH THE MOTOR RUNNING.

**⚠ CAUTION:** NEVER cut with the bar-mount sharpener installed.

**⚠ CAUTION:** Use caution when removing the sharpener: the bar and chain may be hot due to the friction generated during sharpening.

1) After sharpening, turn the saw off. 2) Remove the bar-mount sharpener by unlatching and opening the cover and removing from the guide bar. 3) Close and latch the cover to prevent accidental overextension of the hinge, which could damage the bar-mount sharpener. 4) Make a test cut to determine if the chain has been sufficiently sharpened. If not, repeat the sharpening procedure until the chain is sufficiently sharp.

### HOW TO TELL WHEN TO REPLACE THE CHAIN AND STONE

The chain and stone are meant to be a matched pair.

Replace BOTH when:

- there is a sudden drop in the amount of sparks generated when attempting to sharpen the chain. The stone is worn out.
- the cutting speed of the chain is unsatisfactorily slow and repeated sharpenings do not improve the cutting speed. The chain is worn out.

**⚠ WARNING:** IMPROPER USE OR MAINTENANCE OF SAW CHAIN CAN INCREASE RISK OF LOSS OF CONTROL OF THE CHAIN SAW CAUSING SERIOUS INJURY TO THE OPERATOR OR BYSTANDERS. FOLLOW ALL MAINTENANCE INSTRUCTIONS AND SAFETY PRECAUTIONS FOR THESE PRODUCTS.

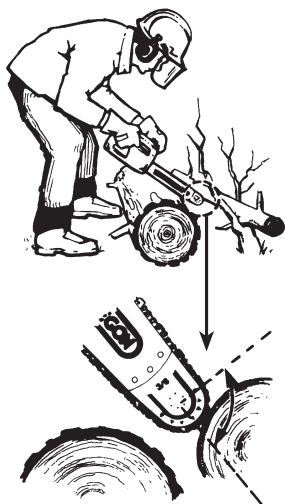

## CHAIN SAW SAFETY

### GUARD AGAINST THE DANGER OF CHAIN SAW KICKBACK

**Kickback is an extremely fast, backward and/or upward motion of the chain saw occurring when the saw chain near the nose or top area of the guide bar contacts any object, or when the wood closes in and pinches the guide bar.**

- All saw chain can kick back.
- Kickback can lead to dangerous loss of control of the chain saw which can result in serious personal injury to saw operator or to bystanders.
- Avoid contact of the upper quadrant of the guide bar nose with any object.

## Read and Follow All Instructions in This Sheet And in Your Chain Saw Operator's Manual

### NEVER

- attempt to operate a chain saw without first receiving qualified operating and maintenance instructions
- let the tip of the bar and chain contact other objects while the chain is moving
- cut with loose or dull chain
- cut in unsteady positions (off-balance, out-stretched arms, one handed, over-reaching, on a ladder, or in a tree)

### ALWAYS

- read the chain saw operator's manual
- maintain this saw chain strictly according to the directions on this instruction sheet
- wear leather gloves, approved eye, ear, head, and face protection
- use both hands and a firm grip
- run the engine at full speed while cutting
- use low-kickback chain and reduced kickback bars

PowerSharp® Complies to the following European Directives:

2006/42/EC; (2006) ISO 12100-1,-2; (2009)

The saw chain in this package is low kickback saw chain. It met the reduced kickback requirements of ANSI B175.1 when tested on a representative sample of chain saws. Type C low-kickback saw chain meets the kickback performance requirements of CSA Standard Z62.3. To learn more about chain saw safety read your saw operator's manual or our Maintenance and Safety Manual, available on request from:



Advanced Cutting Technology

OREGON® SAW CHAIN MAY BE MADE UNDER ONE OR MORE OF THE FOLLOWING PATENT NUMBERS:

5,651,938; 5,666,871; 5,740,715; 5,772,957; 5,974,933; 6,003,423; 6,223,640; 6,748,840; 7,293,491B2 & RE37,288. Patent Pending.

USE OREGON® LOW-KICK CHAIN & REDUCED KICKBACK BARS.

© 2011 OREGON®, Blount, Inc. OREGON® and PowerSharp® are registered trademarks of Blount, Inc. All rights reserved.



INTERNATIONAL

BLOUNT EUROPE SA/NV

Rue Emile Francqui, 5

B 1435 Mont-Saint-Guibert, Belgium

+32 10 30 11 11 +32 10 30 11 99